

soundcore



soundcore Q20i

USER MANUAL

? SUPPORT



Please visit www.soundcore.com/support for more information.

APP



Google Play and the Google Play logo are trademarks of Google Inc.



Apple and the Apple logo are trademarks of Apple Inc.



Download the soundcore app to switch ambient sound modes, adjust EQ settings, update firmware, and explore more. If your headphones cannot connect with the soundcore app, re-install the app or update it to the latest version in your mobile app store.

WEARING

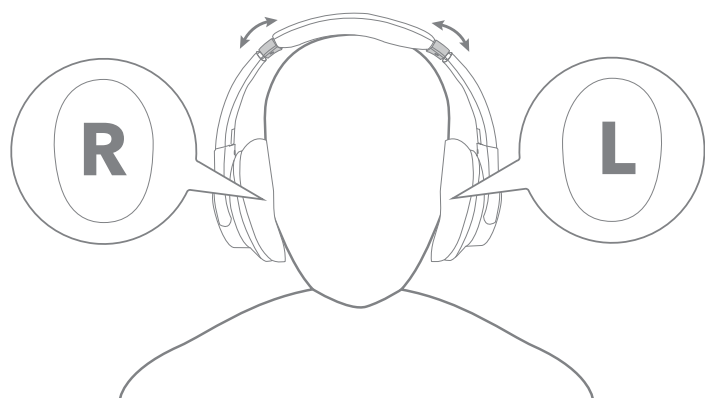

Wear the headphones with the "L" logo on your left ear and "R" logo on your right ear. Adjust the length of the headband for a comfortable fit.

CHARGING

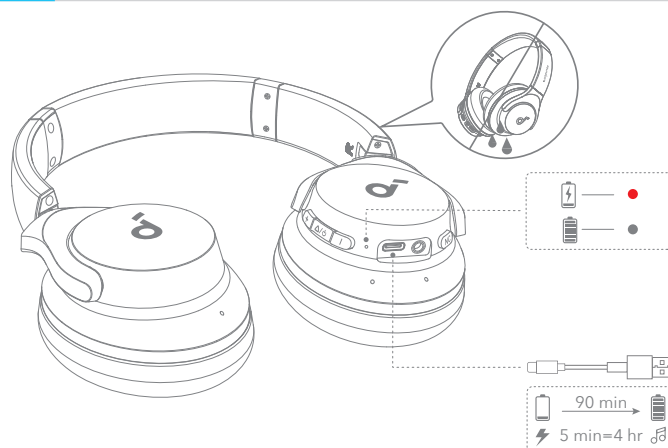

Fully dry off the headphones and USB-C charging port before charging.

Do not turn on your headphones while charging. Use a certified USB-C charging cable and charger to prevent any damage.

POWERING ON & PAIRING

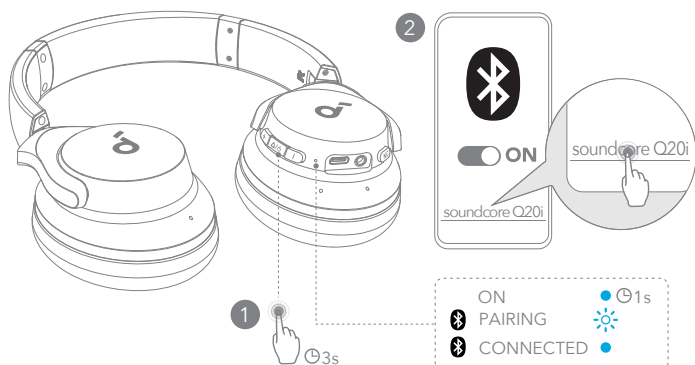

Press and hold the multi-function button for 3 seconds to power on. The headphones will automatically enter Bluetooth pairing mode when connecting for the first time. Select **soundcore Q20i *** on your device's Bluetooth list when connecting for the first time.

*The device name may vary depending on the region.

MANUAL PAIRING

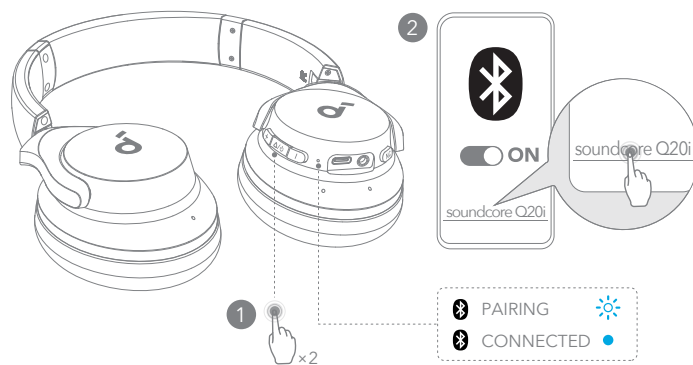

To manually enter Bluetooth pairing mode, after powering on the headphones, press the multi-function button twice to pair.



DUAL CONNECTIONS

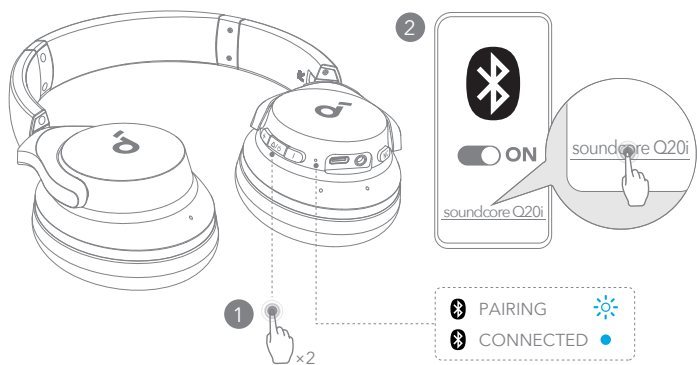

The headphones can connect with two devices at the same time.

When already connected to one device, press the multi-function button twice to pair with another device.



BUTTON CONTROLS

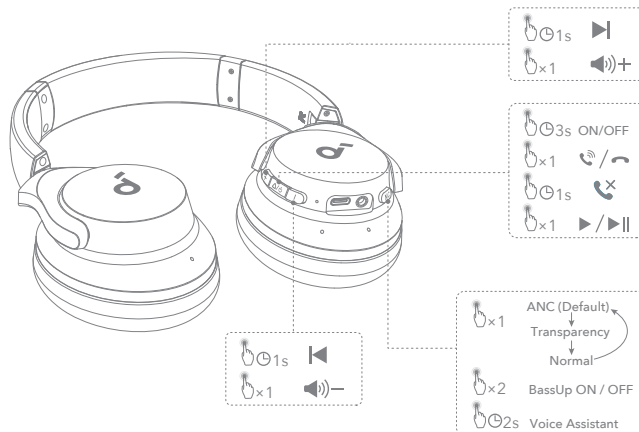

×1: Press once

×2: Press twice

2s: Press and hold for 2 seconds

1s: Press and hold for 1 second



BUTTON CONTROLS

	Switch ambient sound modes (ANC / Transparency / Normal)	NC	Press once
	BassUp on / off	NC	Press twice
	Power on / off		Press and hold for 3 seconds
	Play / Pause		Press once
	Next track		Press and hold for 1 seconds
	Previous track		Press and hold for 1 seconds
	Volume up		Press once
	Volume down		Press once
	Answer / End a call		Press once
	Reject a call		Press and hold for 1 seconds
	Activate Voice Assistant	NC	Press and hold for 2 seconds



AMBIENT SOUND

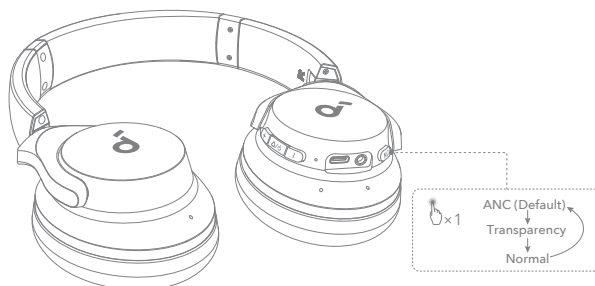

Active Noise Cancellation (ANC): Reduce unwanted background noise.

Transparency: Stay aware of your surroundings while listening to music.

AUX



WIRED LISTENING

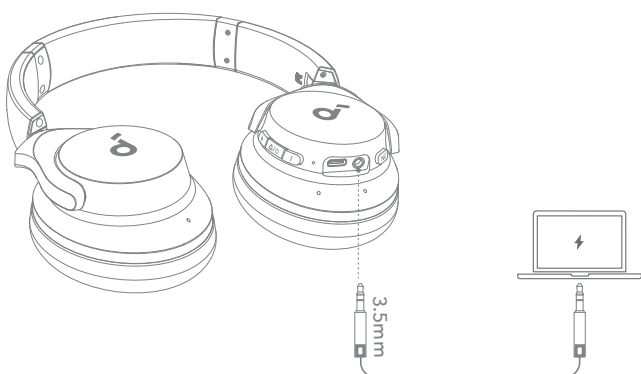

Play audio on an external device by plugging in a 3.5mm AUX cable. Wired listening will automatically turn off Bluetooth mode.

*When using an AUX cable, the ANC function will be disabled.



RESET

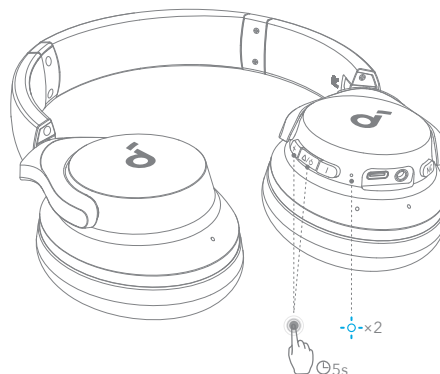

You might need to reset your headphones if you experience connectivity or function issues.

Delete the pairing history from your Bluetooth device first.

Press and hold the volume up and multi-function button simultaneously for 5 seconds until the LED flashes blue twice.

LED LIGHT GUIDE

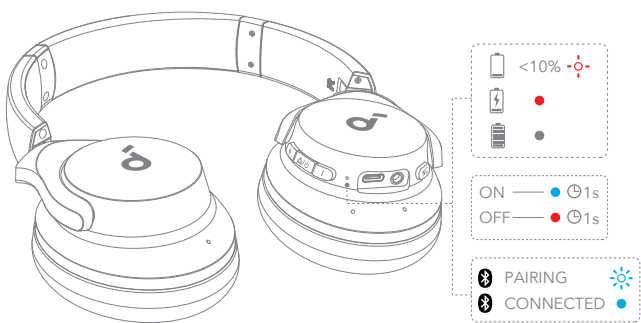

- Flashing red
- Steady red
- Flashing blue rapidly

- Steady blue
- Light off

FIRMWARE UPDATE

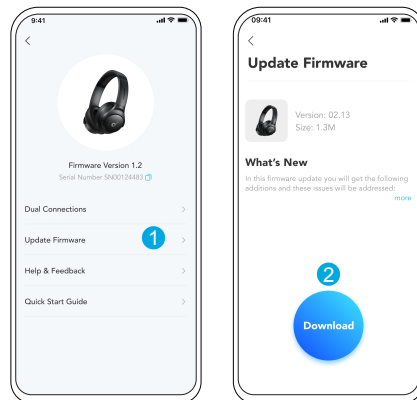

You will be informed once the new version of firmware is detected when you connect the headphones with the app. Ensure the headphones are powered on and connected to a device until the firmware update is complete. During the update, avoid any usage and ensure stable access to the internet.

SPECS

Specifications are subject to change without notice.

Input	5 V $\overline{\text{---}}$ 0.75 A
Rated output power	2.5 mW
Battery capacity	800 mAh
Charging time	90 minutes
Playtime (with ANC off)	Up to 60 hours
Playtime (with ANC on)	Up to 40 hours
Driver size	40 mm
Frequency response	20 Hz - 20 kHz
Impedance	16 Ω
Bluetooth version	5.0
Bluetooth range	10 m / 32.8 ft