



# SMART GRILL AND SANDWICH PRESS

KASWPRSMGRA



# SAFETY & WARNINGS

When using electrical appliances, basic precautions should always be followed, including the following:

- Read all instructions before use and retain this user guide for future reference.
- Do not touch hot surfaces. Always use handles or knobs.
- Before using, ensure that the electrical rating of the power socket corresponds to that of the appliance.
- To protect against fire, electric shock and injury to persons, do not immerse cord, plug or the grill in water or other liquid.
- If the supply cord is damaged, cease immediately and contact help.Kogan.com for support.
- Close supervision is necessary when any appliance is used by or near children.
- Unplug from the outlet when not in use and before cleaning. Allow to cool before putting on or taking off parts and before cleaning the appliance.
- Do not operate any appliance with a damaged cord or plug or after the appliance malfunctions or has been damaged in any manner. Cease immediately and contact help.Kogan.com for support.
- The use of accessory attachments not supplied by Kogan.com may result in fire, electric shock or injury to persons.
- Do not use outdoors.
- Do not let cord hang over edge of table or counter or touch hot surface.
- Do not place on or near a hot gas or electric burner or in a heated oven.
- Extreme caution must be used when moving an appliance containing hot oil or other hot liquids.
- To disconnect, press the power button and then remove plug from electrical outlet.
- Do not use appliance for other than intended use.
- The appliance must not be used with an external timer or remote-control system. Don't use an accessory not supplied by Kogan.com.
- Do not place food wrapped in plastic film, polythene bags or metal foil in the grill. Doing so may damage the grill and may cause a fire hazard.
- Do not leave food to cool on the grill. Remove food while hot.
- Do not use metal or sharp utensils on the grill. Doing so may damage the non-stick cooking surface. Use wooden or plastic spatulas or tongs.

- This appliance is not intended for used by persons (including children) with reduced physical, sensory or mental capabilities or lack of experience and knowledge, unless they have been given supervision or instruction concerning use of the appliances by a person responsible for their safety.
- Children should be supervised to ensure that they do not play with the appliance.
- Warning: charcoal or similar combustible fuels must not be used with this appliance.
- Caution: This appliance generates heat and escaping steam during use. Take proper measures to prevent injury, burn or fire.
- This appliance is intended to be used in household and similar applications such as:
  - Staff kitchen areas in shops, offices and other working environments.
  - Farmhouses.
  - By clients in hotels, motels and other residential type environments.
  - Bed and breakfast type environments

# OVERVIEW

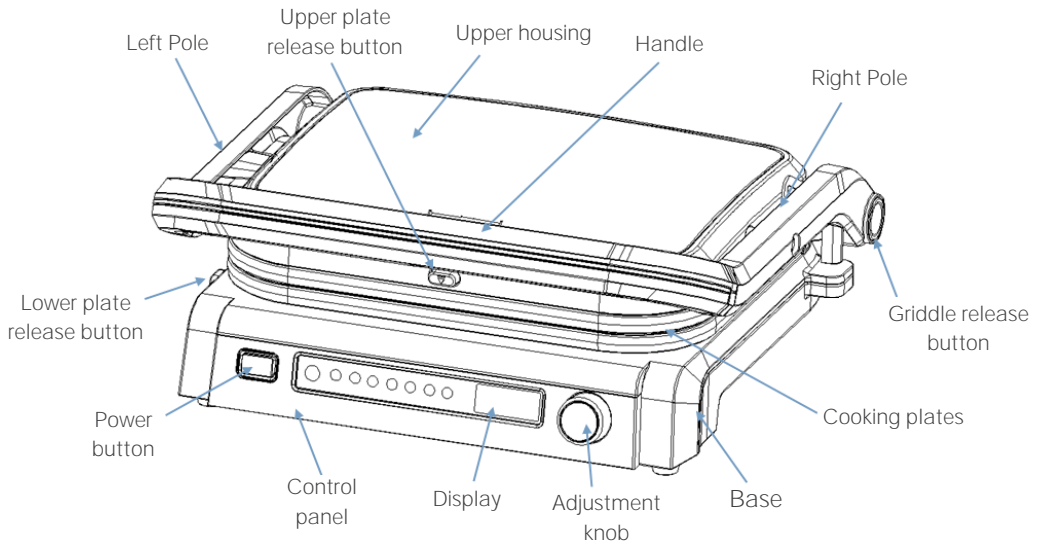

## Control panel

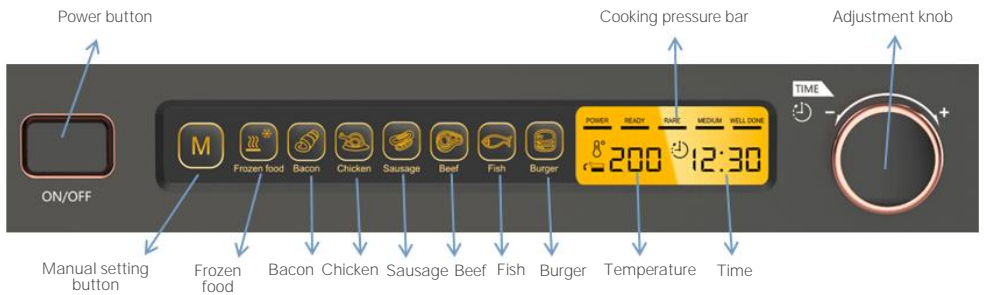

# BEFORE FIRST USE

1. Take the appliance out of the packaging and remove all the packaging material. Check the appliance to ensure all components are present before disposing of any packaging material.
2. Remove the upper and lower grill plates by pressing the release buttons.
3. Before using it for the first time, clean the grill plates with warm water and a mild cleaning agent, then thoroughly dry the parts.
4. Replace the grill plates, ensuring they are properly in place.

# OPERATION

## Turning the unit On/Off

1. Close the lid and plug in.
2. Press the power button, the indicator lights of the functional buttons will gradually illuminate.
3. Press the power button again to turn the unit off

## Manual setting mode: (can be used with lid opened or closed)

1. After pressing the power button, press the Manual setting (M) button, the indicator of this button will stay on.
2. The default temperature “200°C” will flash. Set the desired temperature by turning the adjustment knob then press the adjustment knob to confirm.
3. The default time “60:00” will flash set desired time by turning the adjustment knob then press the adjustment knob to confirm.
4. The unit will begin to preheat, the “POWER” bar will flash. When the cooking plates reach the set temperature, the unit will emit 3 “beeps” and the “POWER” bar will be solid.
5. Place food in the sandwich press.
6. “READY”, “RARE”, “MEDIUM” & “WELL DONE” bar will illuminate gradually. The unit will emit 3 “beeps” when cooking has finished.

Smart cooking mode: (can only be used when lid be closed)

1. After pressing the power button, press one of the 7 function buttons (frozen food, bacon, chicken, sausage, beef, fish & burger), the indicator of this button will stay on. Press the adjustment knob to confirm.
2. The unit will begin to preheat, the “POWER” bar will flash. When the cooking plates reach the set temperature, the unit will emit 3 “beeps” and the “POWER” bar will be solid.
3. Place food in the sandwich press and close the lid. The unit will detect the thickness of the food and set the corresponding cooking time and temperature automatically.
4. The “READY” bar will be solid, and the “RARE” bar will begin flashing. Time on display start to count down accordingly.
5. “RARE” “MEDIUM” “WELL DONE” gradually illuminate. When time shows “00:00”, The unit will emit 8 “beeps” when cooking has finished.

Griddle

1. Press the griddle release button and open the sandwich press so that both grill plates are facing upwards.
2. When the grill is open it can only be used in manual setting mode. The 7 functions buttons will be inactive.

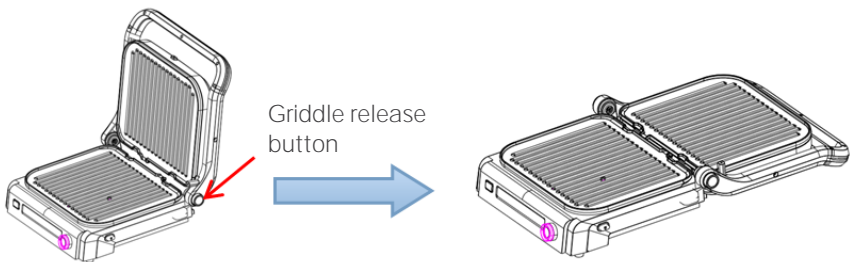

Tips:

- For best results, lightly coat the cooking plates with a little cooking oil or cooking spray.
- Close up the plates when preheating. After the preheating is done, if you do place food in the press, the appliance will automatically turn off after a few minutes.

Note: Manual mode does not have detection function so it will keep running for approximately 2 hours until the appliance turns off automatically.

- When the food is cooked, use the handle to open the lid. Remove the food with a plastic heat-resistant spatula. Never use metal tongs or a knife as these can cause damage to the non-stick coating of the cooking plates.
- When using the beef function, the unit will “beep” for “RARE, MEDIUM and WELL DONE”. For all other functions, the unit will only “beep” for “WELL DONE”.
- The maximum thickness of food is 5cm and the minimum thickness is 1cm for all modes except for bacon.
- For thin pieces of beef with thickness less than 1 cm, it is recommended to use manual setting mode, flipping the meat about every minute. This will ensure that the surface browns evenly throughout and that the middle will not overcook.
- For meat and beef steak, it is normal that cooking results may vary depending on type, quality and origin of food.



# CLEANING & CARE

- This product contains no user serviceable parts. Only licenced service personnel should perform any repairs.
- Before cleaning, disconnect the appliance from power and allow it to cool down completely. Note: If the grill is very hot. It will take a while to cool down.
- Press the release button and remove the grill plates.
- After disassembling the plates, wash them warm soapy water or in a dishwasher. Dry the trays before replacing them on the grill.

## Note:

Before removing the plates, ensure the temperature of oil or oil residues in the drip box must be lower than 40°C, otherwise it may burn person for high temperature.

- Wipe other surfaces of the grill with a clean damp cloth. Use a paper towel with a little cooking oil to remove any stubborn stains.
- Reassemble the grill plates.
- Do not immerse the appliance into water or other liquids.
- Do not use harsh or abrasive cleanser or solvent.
- Never use scourers, wire wool or soap pads.

## Storage

1. Before storing the grill, make sure the grill is clean and dry thoroughly.
2. Close the grill and rest it flatly.
3. Store the grill in a cool dry area out of the reach of children. The grill cannot be rested vertically.

## Disposal



This marking indicates that this appliance should not be disposed with other household wastes. To prevent possible harm to the environment or human health from uncontrolled waste disposal, recycle it responsibly to promote the sustainable reuse of material resources.



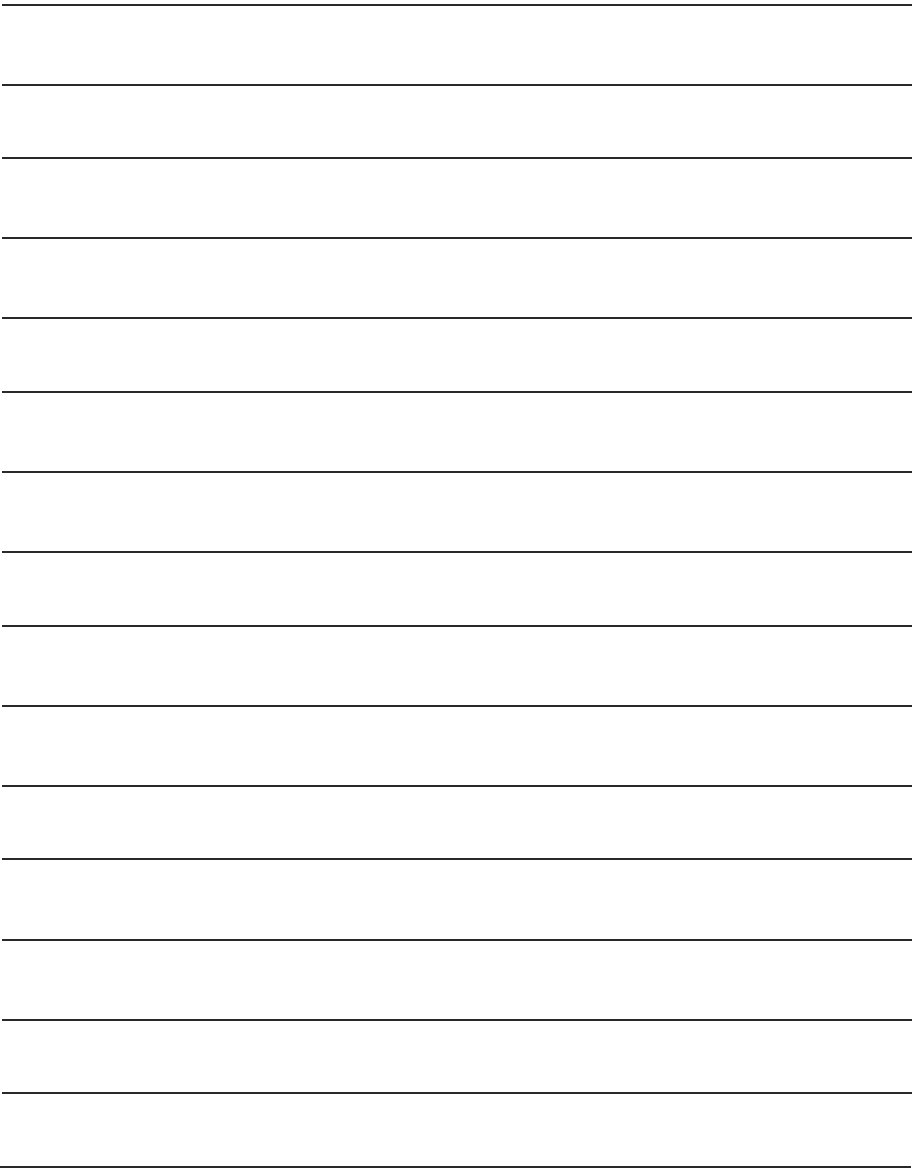

Need more information?

We hope that this user guide has given you the assistance needed for a simple set-up.

For the most up-to-date guide for your product, as well as any additional assistance you may require, head online to [help.kogan.com](http://help.kogan.com)

**kogan.com**